

## Misty 2.5

(Model #10025)



**CAUTION**



**NEVER** DISMANTLE ANY OF THIS PRODUCT AFTER IT HAS BEEN PRESSURIZED. **DO NOT** OVERPRESSURIZE. BOTH ACTIONS CAN RESULT IN SERIOUS INJURY!

### Instructions for Use:

#### Step 1: Unscrew Cap and Fill

- Twist the cap counter clockwise to separate and remove from the bottle.  
(See Figure 1)

- Add water to the bottle up to the “Fill Line” (See Figure 2)

*Note: Overfilling the bottle will restrict the mister from pressurizing to its maximum potential.*

- Replace the cap onto the bottle and gently tighten

*Note: Applying too much force when screwing on the cap can damage the unit. Be sure not to over-rotate the cap.*

#### Step 2: Pressurize

- Hold the bottle firmly with one hand, and gently grab the colored base of the bottle with the other hand.
- Pump the mister 10 – 15 times by gently sliding the base in and out of the bottle. It is normal to feel resistance as you pressurize the mister. (See Figure 3)

*Note: Use short quick pumps to add pressure. Damage can occur if the shaft is pumped with too much force.*

*Note: The base will not fit comfortably inside the bottle if too much pressure is applied. (See **Depressurization Instructions below**)*

#### Step 3: Mist

- Press the “Mist” button as needed to enjoy the ultrafine and refreshing mist  
(See Figure 4)

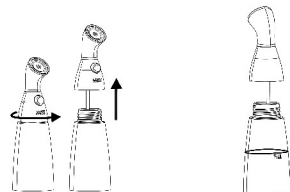

Figure 1

Figure 2

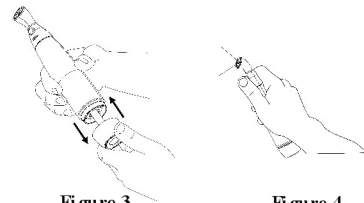

Figure 3

Figure 4

### Care and Cleaning:

- Using water with impurities can severely shorten the life of the nozzle and the mister. Only use the cleanest water with the product (purified or distilled)
- **NEVER** open the cap after you have applied pressure to the bottle or pumped it at all. Depressurize unit first. **Depressurize (hold the bottle upside-down with the nozzle facing the ground and press the ‘Mist’ button for 5-10 second. Air and some water will come out and you should be able to safely remove the cap.)**
- To clean, rinse bottle with soap and water; Air dry bottle upside-down and be sure no sitting water is in the tubing.